

TYPICAL 2 BEDROOM NORTHERLY ASPECT

Residential Tower 2
 Level 2 - Level 9

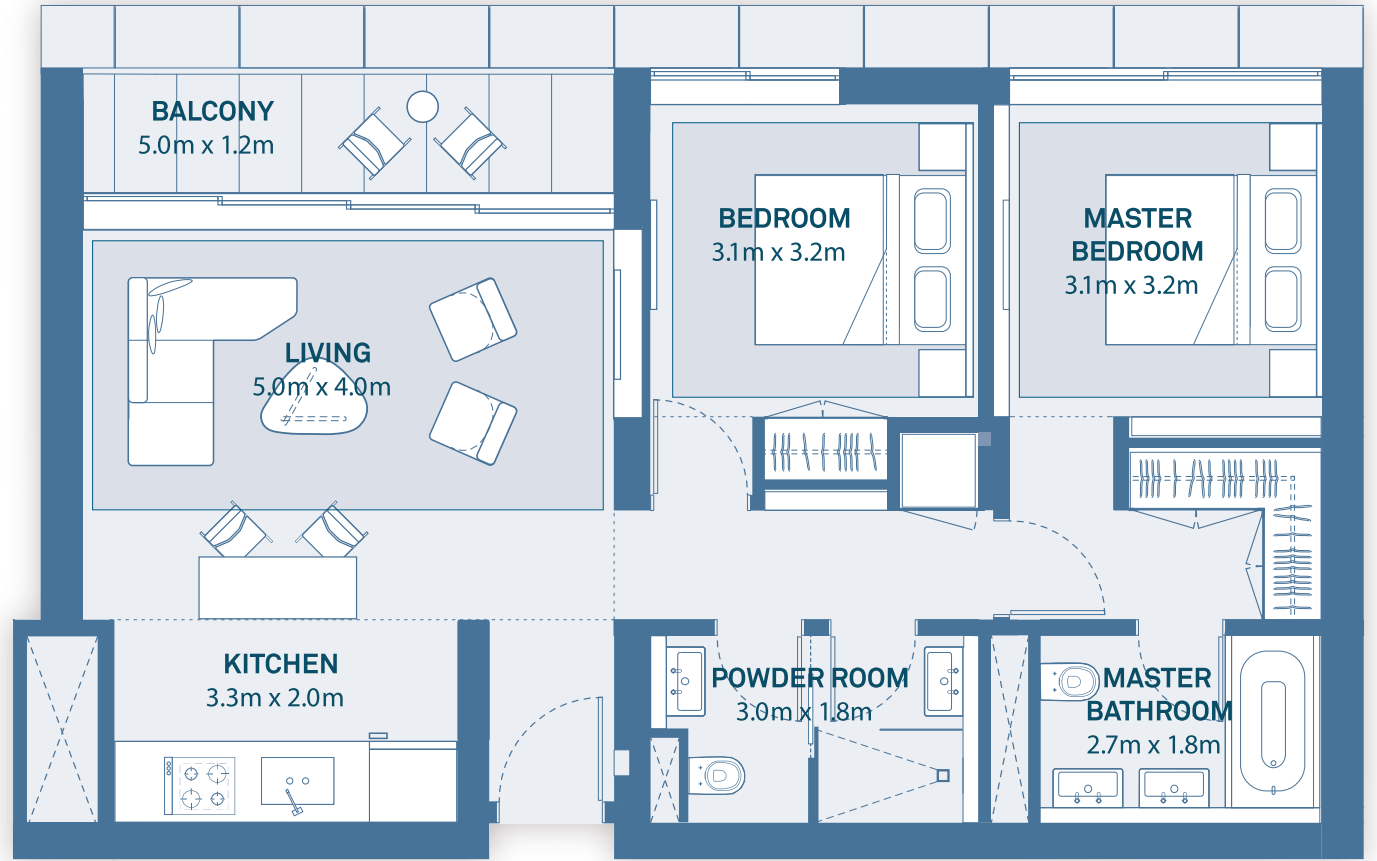

Suite Area 84.5 sq. m

Balcony Area 6 sq. m

Total Area 90.5 sq. m

KEY PLAN

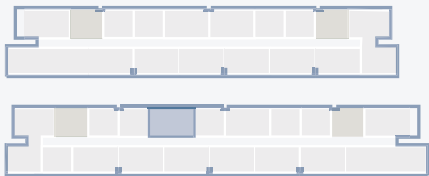

Blue – Displayed Floor Plan
 Green – Mirrored Floor Plan

Disclaimer: 1. All room dimensions are measured to structural elements and exclude all finishes and construction tolerances. 2. All dimensions have been provided by our consultant architects. 3. All materials, dimensions and drawings are approximate. Information is subject to change without notice. 4. The attached plans are for marketing purposes only. Actual suite area may vary from the stated area. Drawings not to scale. The developer reserves the right to make revisions. 5. The suite area is measured as the area bounded by the centerlines of demising of party walls separating one unit from another unit, the centerline surface of the exterior walls, and the centerline surface of the corridor wall enclosing and abutting the Unit. 6. The balcony area is measured as the area bounded by the inner face of a solid masonry demising or party walls separating one unit from another unit, the centerline of the enclosing guard and the centerline of the suite abutting the balcony. Where a balcony is split to service two adjacent units and the split is constructed using a glazed panel, the balcony area of each unit is measured to the centerline of the glazed panel. 7. The units are measured at typical floor in the building. Columns may vary in size depending on the floor level.

TYPICAL 2 BEDROOM NORTHERLY ASPECT

Residential Towers 1,2

Tower 1: Level 1 - Level 9

Tower 2: Level 2 - Level 9

Suite Area	84.5 sq. m
Balcony Area	6 sq. m
Total Area	90.5 sq. m

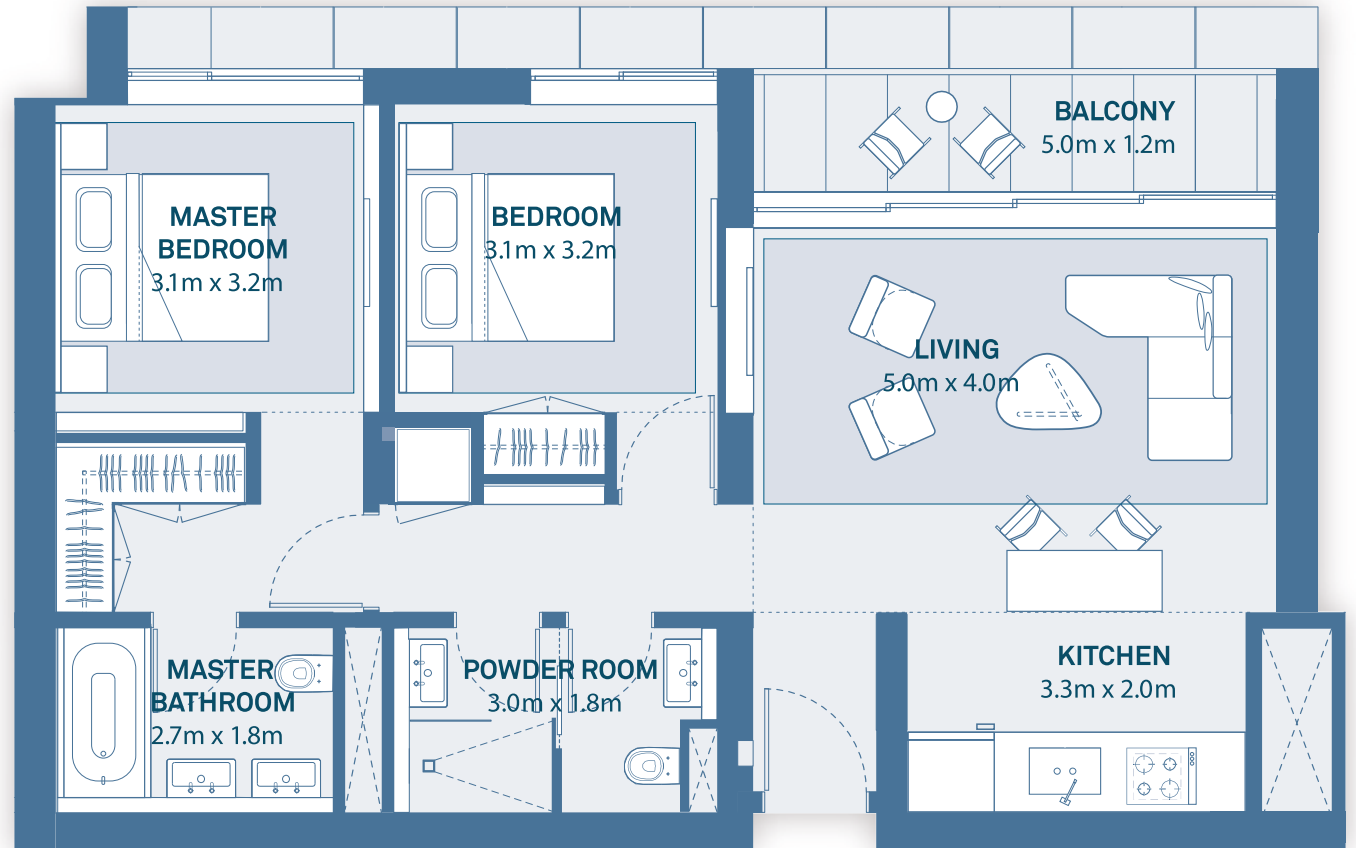

KEY PLAN

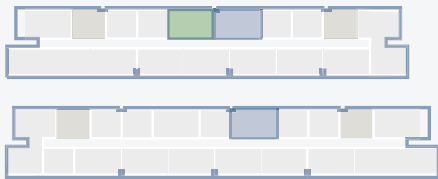

Blue – Displayed Floor Plan
 Green – Mirrored Floor Plan

Disclaimer: 1. All room dimensions are measured to structural elements and exclude all finishes and construction tolerances. 2. All dimensions have been provided by our consultant architects. 3. All materials, dimensions and drawings are approximate. Information is subject to change without notice. 4. The attached plans are for marketing purposes only. Actual suite area may vary from the stated area. Drawings not to scale. The developer reserves the right to make revisions. 5. The suite area is measured as the area bounded by the centrelines of demising of party walls separating one unit from another unit, the centreline surface of the exterior walls, and the centreline surface of the corridor wall enclosing and abutting the Unit. 6. The balcony area is measured as the area bounded by the inner face of a solid masonry demising or party walls separating one unit from another unit, the centreline of the enclosing guard and the centreline of the suite abutting the balcony. Where a balcony is split to service two adjacent units and the split is constructed using a glazed panel, the balcony area of each unit is measured to the centreline of the glazed panel. 7. The units are measured at typical floor in the building. Columns may vary in size depending on the floor level.

**TYPICAL 2 BEDROOM
 SOUTHERLY ASPECT**

Residential Towers 1, 2 - Terrace
 Level 2

Suite Area 84.5 sq. m

Balcony Area 40 sq. m

Total Area 124.5 sq. m

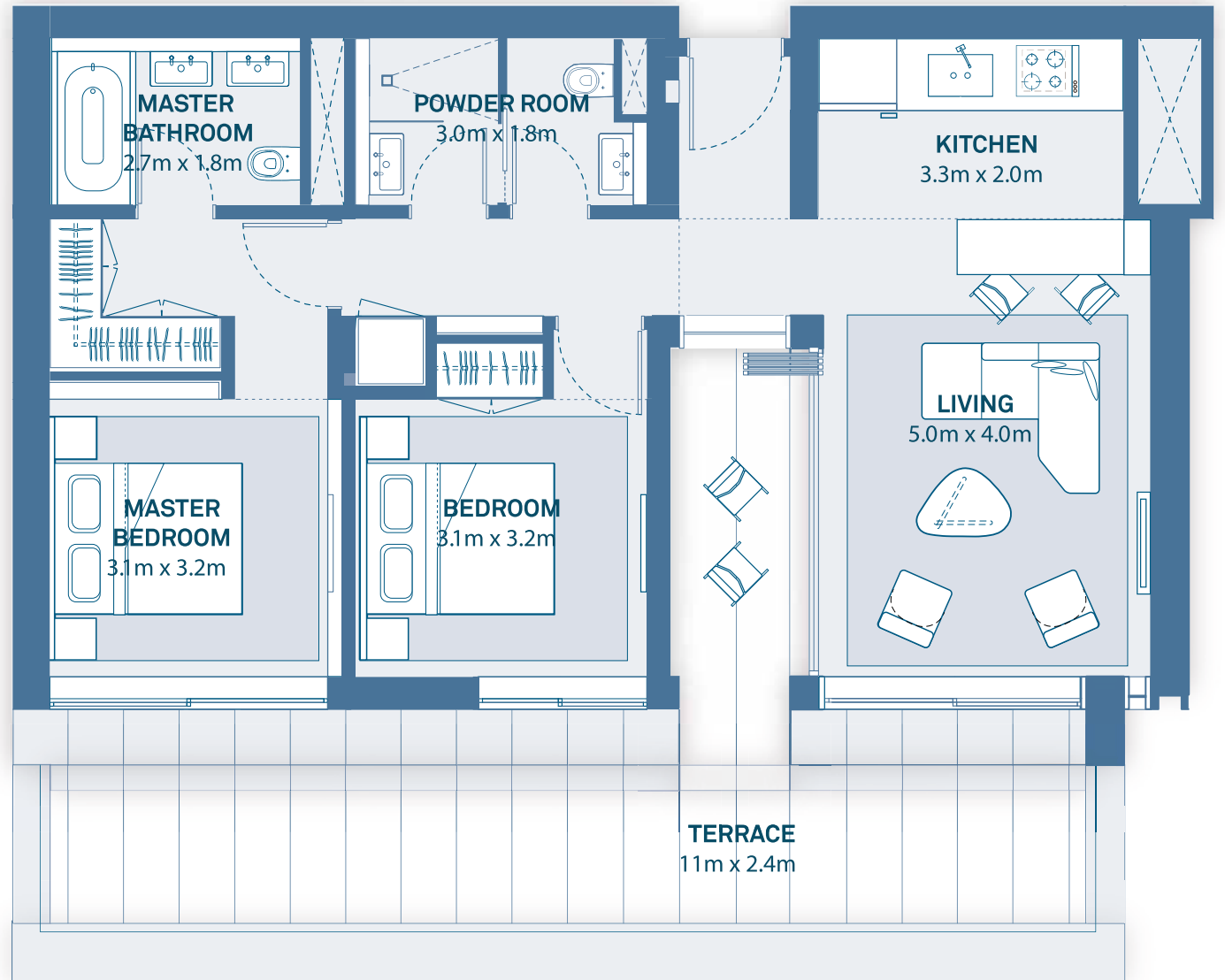

KEY PLAN

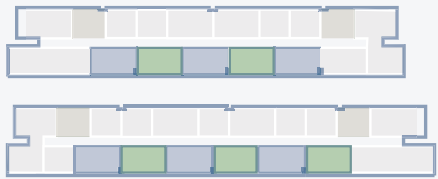

Blue – Displayed Floor Plan
 Green – Mirrored Floor Plan

Disclaimer: 1. All room dimensions are measured to structural elements and exclude all finishes and construction tolerances. 2. All dimensions have been provided by our consultant architects. 3. All materials, dimensions and drawings are approximate. Information is subject to change without notice. 4. The attached plans are for marketing purposes only. Actual suite area may vary from the stated area. Drawings not to scale. The developer reserves the right to make revisions. 5. The suite area is measured as the area bounded by the centrelines of demising of party walls separating one unit from another unit, the centreline surface of the exterior walls, and the centreline surface of the corridor wall enclosing and abutting the Unit. 6. The balcony area is measured as the area bounded by the inner face of a solid masonry demising or party walls separating one unit from another unit, the centreline of the enclosing guard and the centreline of the suite abutting the balcony. Where a balcony is split to service two adjacent units and the split is constructed using a glazed panel, the balcony area of each unit is measured to the centreline of the glazed panel. 7. The units are measured at typical floor in the building. Columns may vary in size depending on the floor level.

TYPICAL 2 BEDROOM SOUTHERLY ASPECT

Residential Tower 1,2
 Level 3 - Level 9

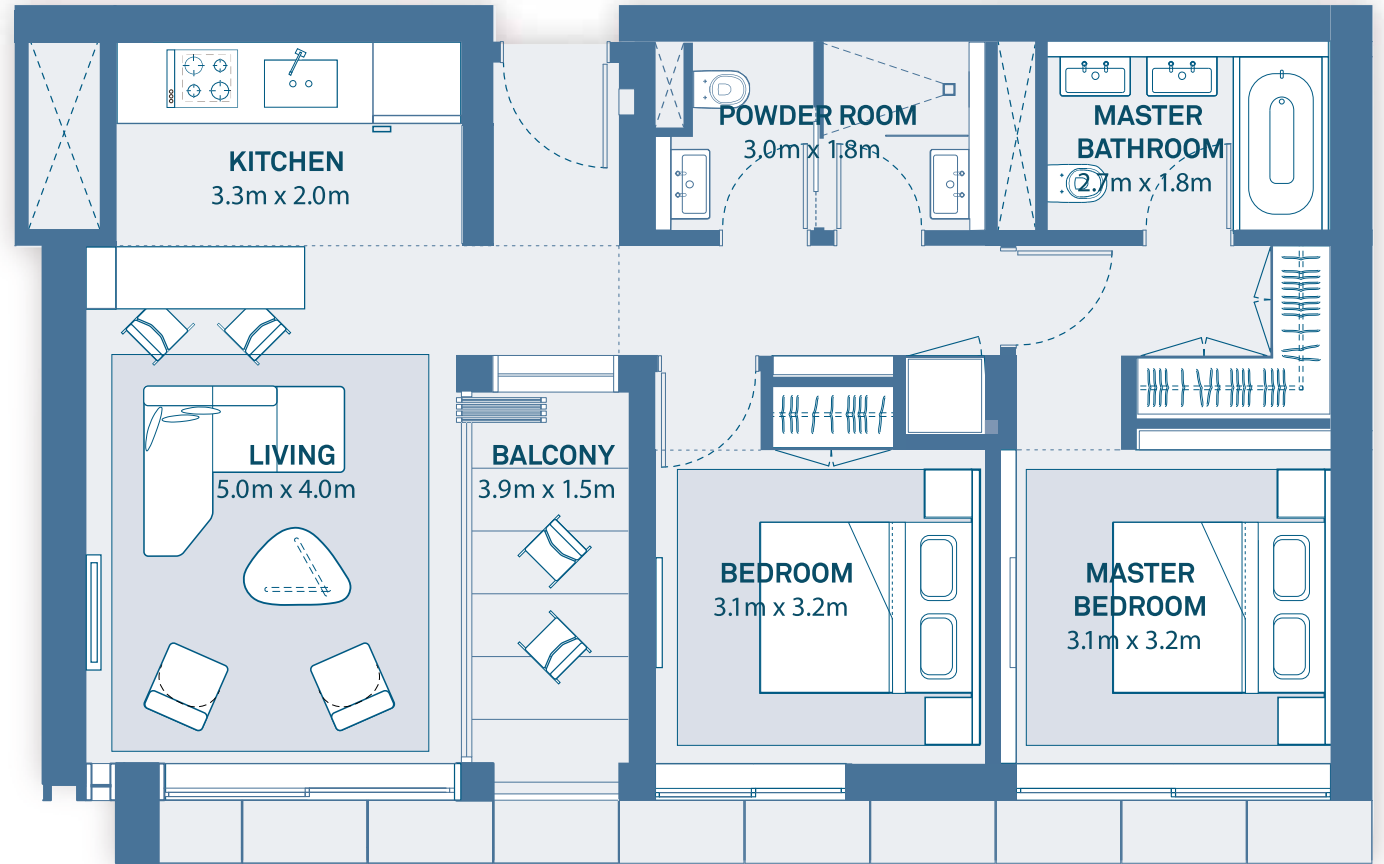

Suite Area 84.5 sq. m

Balcony Area 6 sq. m

Total Area 90.5 sq. m

KEY PLAN

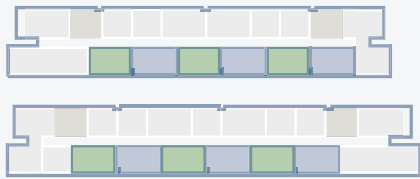

Blue – Displayed Floor Plan
 Green – Mirrored Floor Plan

Disclaimer: 1. All room dimensions are measured to structural elements and exclude all finishes and construction tolerances. 2. All dimensions have been provided by our consultant architects. 3. All materials, dimensions and drawings are approximate. Information is subject to change without notice. 4. The attached plans are for marketing purposes only. Actual suite area may vary from the stated area. Drawings not to scale. The developer reserves the right to make revisions. 5. The suite area is measured as the area bounded by the centrelines of demising of party walls separating one unit from another unit, the centreline surface of the exterior walls, and the centreline surface of the corridor wall enclosing and abutting the Unit. 6. The balcony area is measured as the area bounded by the inner face of a solid masonry demising or party walls separating one unit from another unit, the centreline of the enclosing guard and the centreline of the suite abutting the balcony. Where a balcony is split to service two adjacent units and the split is constructed using a glazed panel, the balcony area of each unit is measured to the centreline of the glazed panel. 7. The units are measured at typical floor in the building. Columns may vary in size depending on the floor level.

**TYPICAL 2 BEDROOM
 NORTHERLY ASPECT**

Residential Tower 1,2

Tower 1: Level 1 - Level 9

Tower 2: Level 2 - Level 9

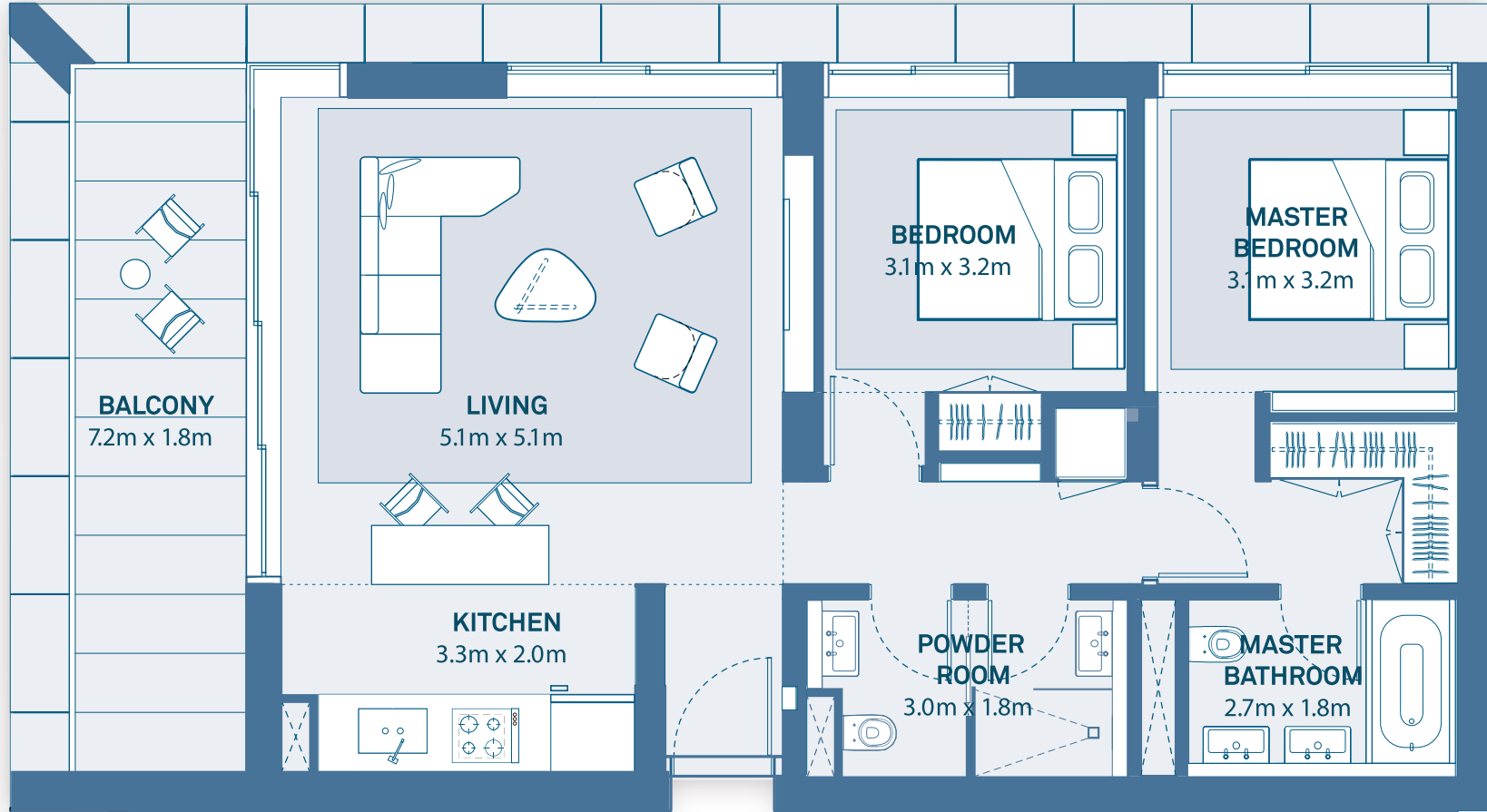

Suite Area	91 sq. m
Balcony Area	14 sq. m
Total Area	105 sq. m

KEY PLAN

Blue – Displayed Floor Plan
 Green – Mirrored Floor Plan

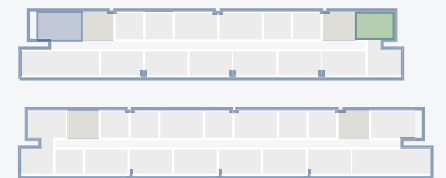

Disclaimer: 1. All room dimensions are measured to structural elements and exclude all finishes and construction tolerances. 2. All dimensions have been provided by our consultant architects. 3. All materials, dimensions and drawings are approximate. Information is subject to change without notice. 4. The attached plans are for marketing purposes only. Actual suite area may vary from the stated area. Drawings not to scale. The developer reserves the right to make revisions. 5. The suite area is measured as the area bounded by the centrelines of demising of party walls separating one unit from another unit, the centreline surface of the exterior walls, and the centreline surface of the corridor wall enclosing and abutting the Unit. 6. The balcony area is measured as the area bounded by the inner face of a solid masonry demising or party walls separating one unit from another unit, the centreline of the enclosing guard and the centreline of the suite abutting the balcony. Where a balcony is split to service two adjacent units and the split is constructed using a glazed panel, the balcony area of each unit is measured to the centreline of the glazed panel. 7. The units are measured at typical floor in the building. Columns may vary in size depending on the floor level.

TYPICAL 2 BEDROOM NORTHERLY ASPECT

Residential Tower 2
 Level 1 - Level 2

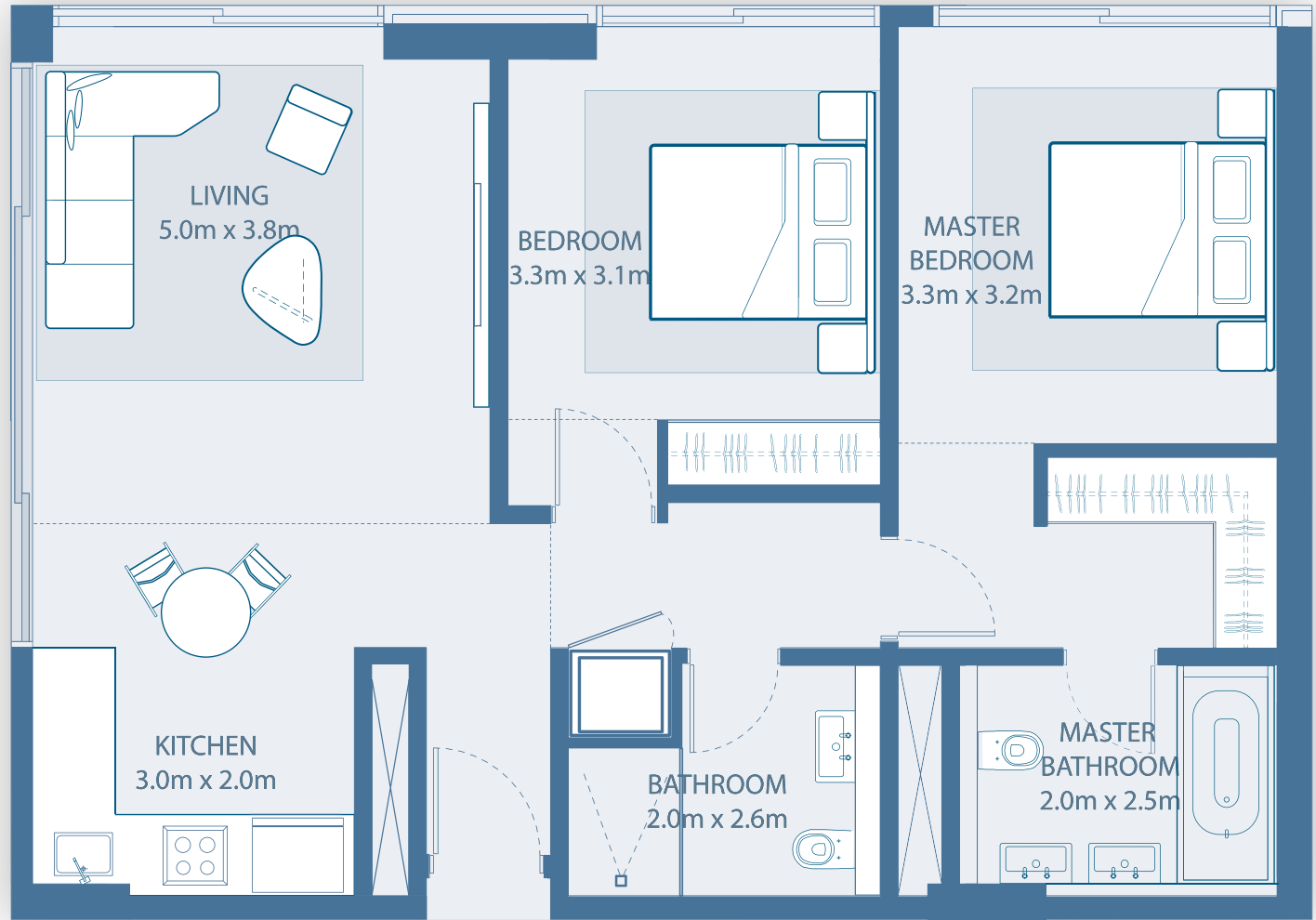

Suite Area	83.5 sq. m
Balcony Area	0 sq. m
Total Area	83.5 sq. m

KEY PLAN

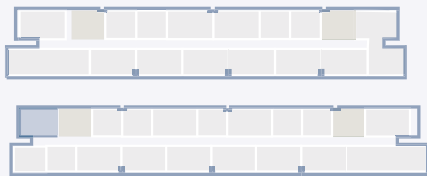

Blue – Displayed Floor Plan
 Green – Mirrored Floor Plan

Disclaimer: 1. All room dimensions are measured to structural elements and exclude all finishes and construction tolerances. 2. All dimensions have been provided by our consultant architects. 3. All materials, dimensions and drawings are approximate. Information is subject to change without notice. 4. The attached plans are for marketing purposes only. Actual suite area may vary from the stated area. Drawings not to scale. The developer reserves the right to make revisions. 5. The suite area is measured as the area bounded by the centerlines of demising of party walls separating one unit from another unit, the centerline surface of the exterior walls, and the centerline surface of the corridor wall enclosing and abutting the Unit. 6. The balcony area is measured as the area bounded by the inner face of a solid masonry demising or party walls separating one unit from another unit, the centerline of the enclosing guard and the centerline of the suite abutting the balcony. Where a balcony is split to service two adjacent units and the split is constructed using a glazed panel, the balcony area of each unit is measured to the centerline of the glazed panel. 7. The units are measured at typical floor in the building. Columns may vary in size depending on the floor level.